

Ku-Band Near Field Probe

12.4 to 18 GHz, WR62

DESCRIPTION

The NFP-150-WR62 is a high-performance open-ended waveguide probe that operates at the Ku-band between 12.4 and 18 GHz. It is manufactured from a single aluminium rod by high accurate manufacturing processes. The opening is sharp to reduce/minimize reflections.

All NFPs can include adequate absorber material to reduce backscattering reflections from flanges.

APPLICATIONS

This type of horns is especially suitable for laboratory test measurements, electromagnetic measurements and gain calibration. Moreover, custom bands and gain values can be requested.

Anteral also offers their **CATR** (Compact Antennas Test Range) for measuring large antennas at significant short ranges in antenna test facilities.

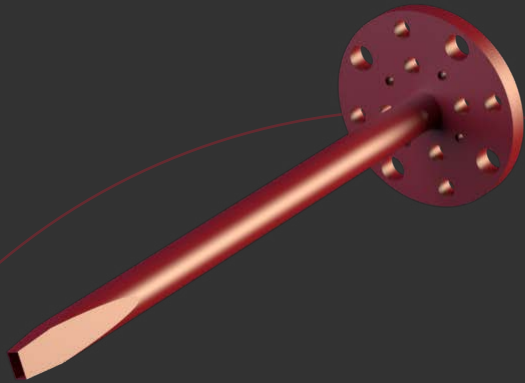

ELECTRICAL SPECIFICATIONS

Parameter	Typical value
Frequency	12.4 - 18 GHz
Directivity	6.5 dBi
S11	-13 dB

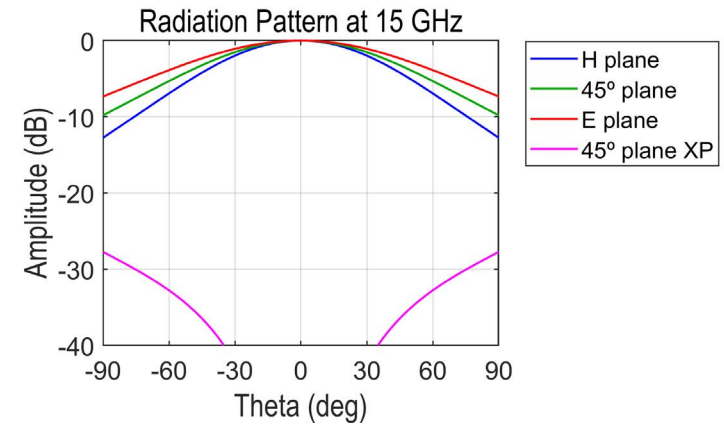
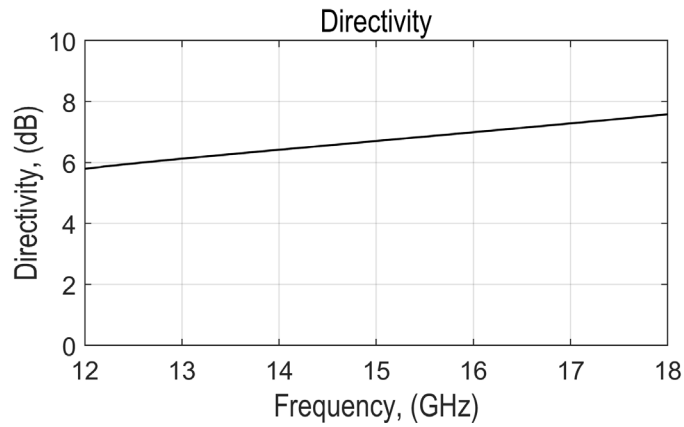
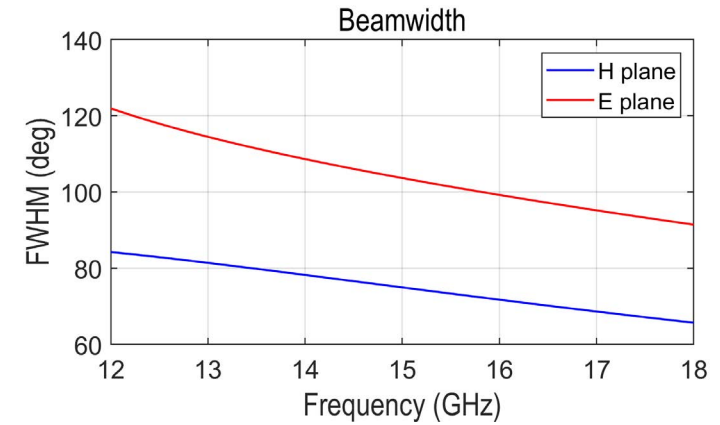

MECHANICAL SPECIFICATIONS

Parameter	Description
Antenna Port	WR-62 (15.799 mm x 7.899 mm)
Flange	UG-419/U -PF (UBR 140 -PF)
Total length	150 mm
Horn Material	Aluminum

MECHANICAL OUTLINE

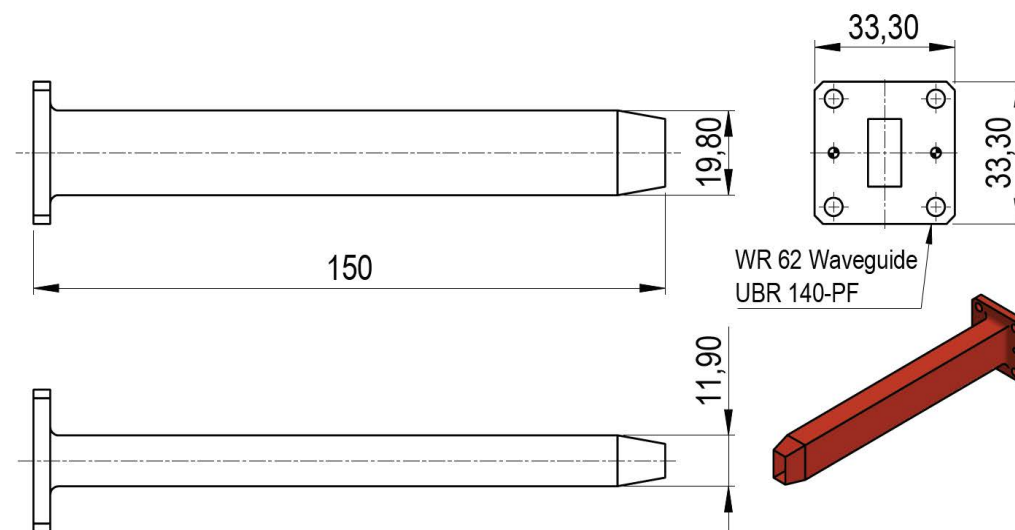

Additional notes

The return loss performance of all items is checked before delivery.

Last version: 06/05/2022.

