

K-Band Near Field Probe

15 to 22 GHz, WR51

DESCRIPTION

The NFP-150-WR51 is a high-performance open-ended waveguide probe that operates at the X-band between 15 and 22 GHz. It is manufactured from a single aluminium rod by high accurate manufacturing processes. The opening is sharp to reduce/minimize reflections.

Under client request, all NFPs can include adequate absorber material to reduce backscattering reflections from flanges.

APPLICATIONS

This type of probes is especially suitable for laboratory antenna near field measurements. Moreover, custom bands and radiation pattern data can be requested for probe correction purposes.

Anteral also offers their **CATR** (Compact Antennas Test Range) for measuring antennas at such antenna test facilities.

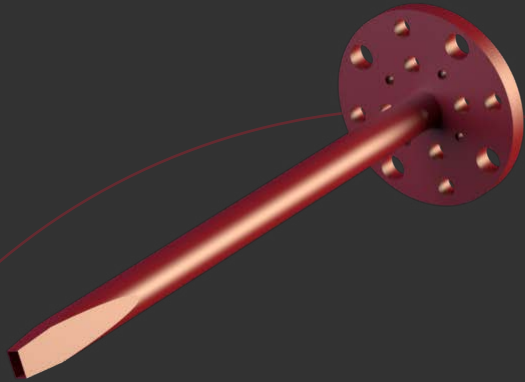

ELECTRICAL SPECIFICATIONS

| Parameter | Typical value |
|-------------|---------------|
| Frequency | 15 - 22 GHz |
| Directivity | 6.5 dBi |
| S11 | -13 dB |

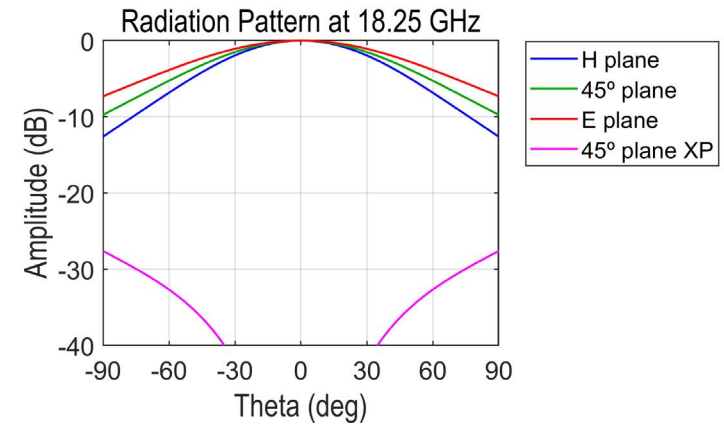
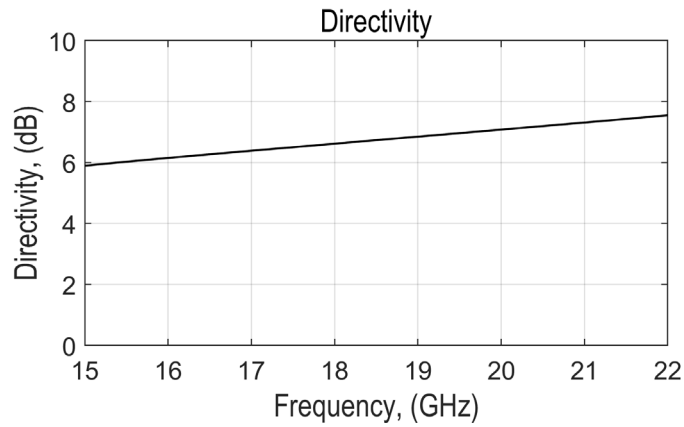
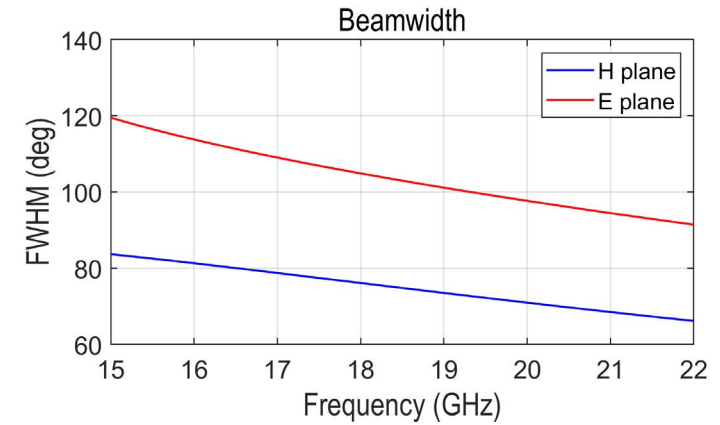

MECHANICAL SPECIFICATIONS

| Parameter | Description |
|---------------|------------------------------|
| Antenna Port | WR-51 (12.954 mm x 6.477 mm) |
| Flange | UBR 180 -PF |
| Total length | 150 mm |
| Horn Material | Aluminum |

MECHANICAL OUTLINE

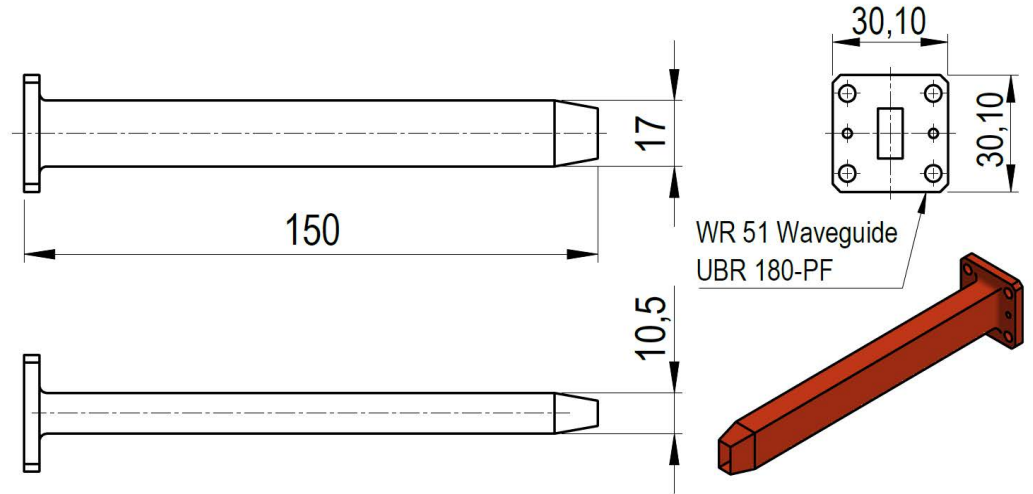

Additional notes

The return loss performance of all items is checked before delivery.

Last version: 06/05/2022.

