

## Near Field Probe

500 to 750 GHz, WR1.5

### DESCRIPTION

The NFP-15-WR1.5 is a high-performance open-ended waveguide probe that operates at the X-band between 500 and 750 GHz. It is manufactured from a single aluminium rod by high accurate manufacturing processes. The opening is sharp to reduce/minimize reflections.

Under client request, all NFPs can include adequate absorber material to reduce backscattering reflections from flanges.

### APPLICATIONS

This type of probes is especially suitable for laboratory antenna near field measurements. Moreover, custom bands and radiation patten data can be requested for probe correction purposes.

Anteral also offers their **CATR** (Compact Antennas Test Range) for measuring antennas at such antenna test facilities.

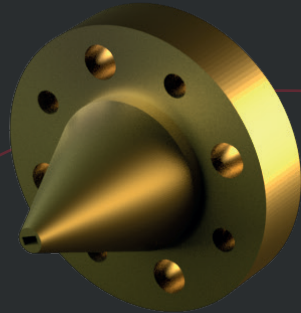

### ELECTRICAL SPECIFICATIONS

Parameter	Typical value
Frequency	500 - 750 GHz
Directivity	6.5 dBi
S11	-13 dB

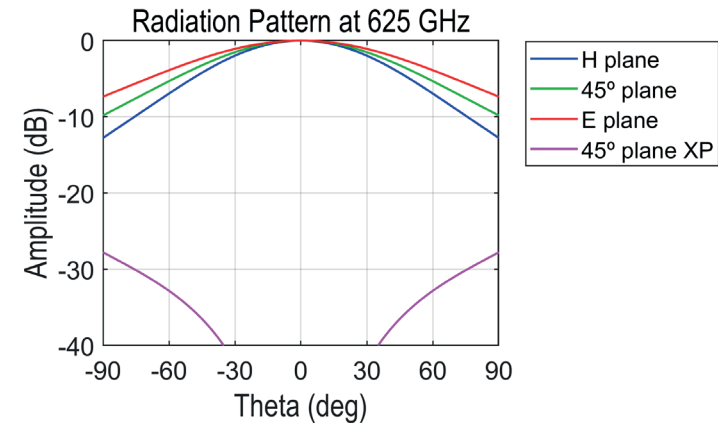
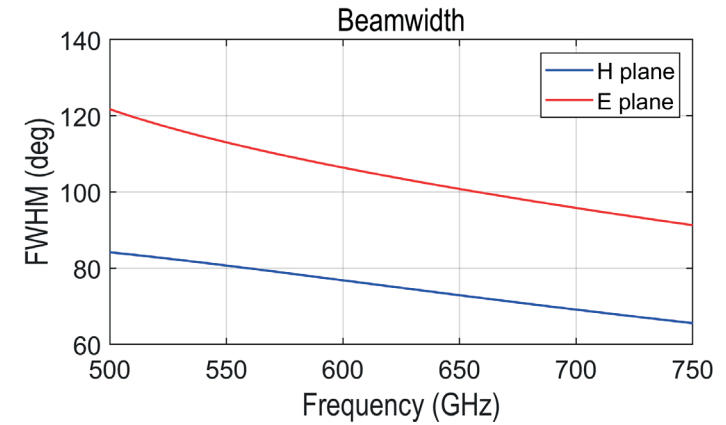
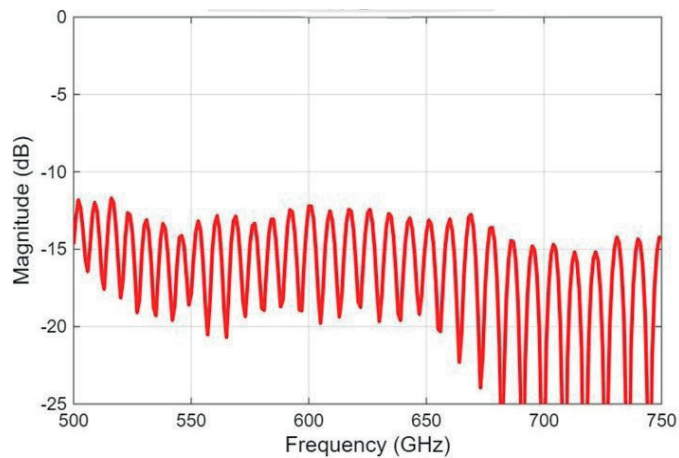
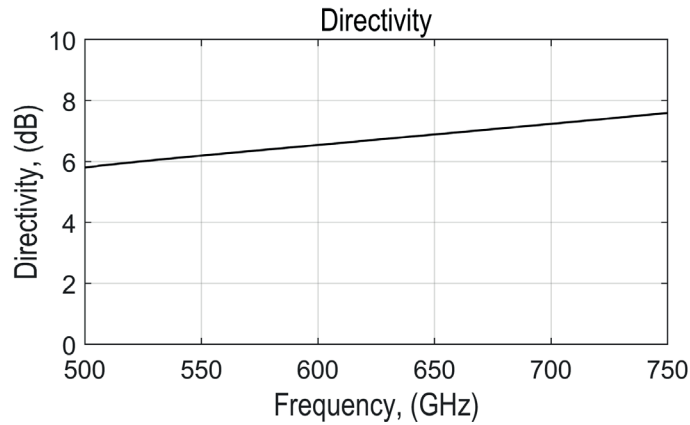

### MECHANICAL SPECIFICATIONS

Parameter	Description
Antenna Port	WR-1.5 (0.380 mm x 0.190 mm)
Flange	UG-387/U
Total length	15 mm
Horn Material	Aluminum

### MECHANICAL OUTLINE

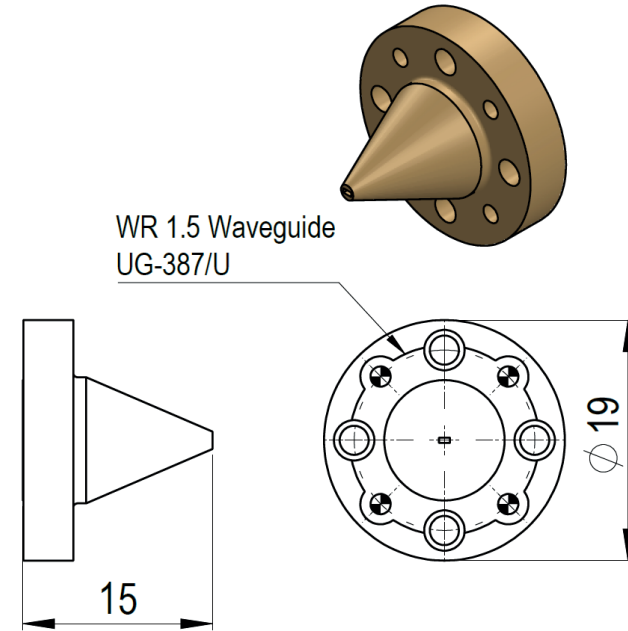

#### Additional notes

The return loss performance of all items is checked before delivery.

Last version: 19/09/2025.

