

UNAUTHORIZED USE OF THIS  
DRAWING IS STRICTLY PROHIBITED

DAR	REV	DESCRIPTION	APPVD	DATE
2753	A	INITIAL RELEASE	DG	11-10
4483	B	SEE DAR	DG	8-13
10026	C	SEE DAR	DG	3-25

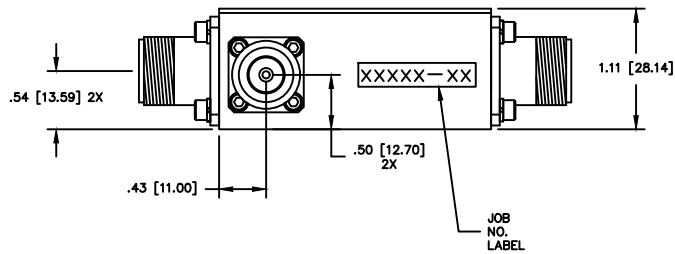
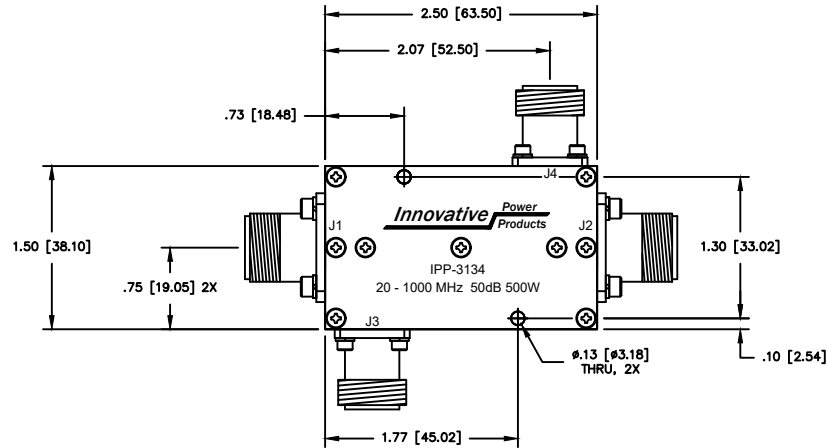

**NOTES**

- CONNECTOR J1 - J4: TYPE "N" FEMALE.
- RoHS COMPLIANT.

**ELECTRICAL SPECIFICATIONS**

FREQUENCY:	20 - 1000 MHz.
INSERTION LOSS:	<0.35 dB
MAIN LINE VSWR:	<1.25:1
DIRECTIVITY:	>20dB
COUPLING:	50.0±1.5dB
COUPLED FLATNESS:	±0.6dB
POWER:	500 WATT
TEMPERATURE:	-55°C TO 85°C

INPUT	OUTPUT	FORWARD COUPLING	REFLECTED COUPLING
J1	J2	J3	J4
J2	J1	J4	J3

MATERIAL	AL. ALLOY	DWN	DG	DATE	9-10		
	6061-T651	ENG	TJD	DATE	9-10		
FINISH	CHEM FILM CLEAR PER MIL-DTL-5541, TYPE 2, REV F, CLASS 3 ROHS COMPLIANT	MANUF		DATE		TITLE	
		CAGE CODE: 437R2		SCALE			DUAL DIRECTIONAL COUPLER 20 - 1000 MHz. 500 WATT, 50 dB IPP-3134
TOLERANCE	.XX ±.02 .XXX ±.005 ANG. ±1/2°	SHEET	OF	SCALE	1:1	SIZE	
		1	1			B	C