

# High Performance End Launch Connector PSF-S06-000/001 (QEL™ SMA)

www.gigalane.com



GigaLane Quick End Launch (QEL™ SMA) is designed for quick launch at the edge of PCB board up to 18 GHz. Specially designed leg immediately adjusts and firmly holds its attachment with the PCB. It is ideal solution for all active & speedy tests required in R&D. When compared with conventional end launch connector, it will effectually reduce soldering and assembly time when deployed in mass production.

## ► Specification

### Electrical

Frequency	DC ~ 18 GHz
Impedance	50 Ω
VSWR	1.2 : 1 (@18GHz)
Insulation Resistance	5000 MΩ
Dielectric Withstand Voltage	1000 Vrms max
Contact Resistance - Outer Conductor - Inner Conductor	2 mΩ max 3 mΩ max
Insertion Loss	0.3 dB max (@18GHz)
RF Leakage	-90 dB
Power Handling	200 W @ 2GHz

### Materials

Body	Stainless Steel Brass	Passivated Gold Plated
Center Contact	Beryllium Copper(BeCu) Brass	Gold Plated Gold Plated
Insulator	PTFE	-

### Mechanical

Mating Cycle (Durability)	500
Recommended Mating Torque Proof Torque	0.9 ~ 1.13 Nm / 8 ~ 10 lbs 1.7 Nm / 15.0 lbs
Coupling Nut Retention Force	270 N / 27.7 kfg / 61 lbs
Center Contact Retention Force	2.6 pound (axial)

### Environmental

Temperature	-40°C ~ +125°C
Thermal Shock	MIL-STD-202, Method 107, Test Condition B
Corrosion (salt Spray)	MIL-STD-202, Method 101, Condition B, 5% salt
Shock	MIL-STD-202, Method 213, Condition I
Vibration	MIL-STD-202, Method 204, Condition D
Moisture Resistance	MIL-STD-202, Method 106

## ► How to install

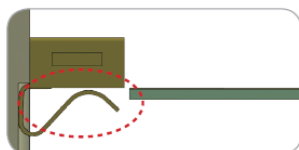
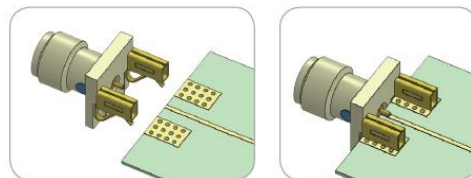

Easy & Speedy insertion

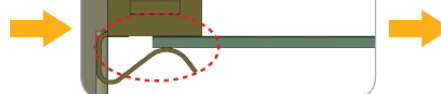

Uniquely designed legs maneuvers smoothly and evenly to fit the PCB thickness

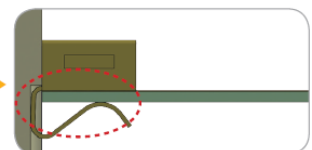

Built-in tension of legs enables even and firm attachment to the PCB

# High Performance End Launch Connector PSF-S06-000/001 (QEL™ SMA)

www.gigalane.com

## ► Drawing

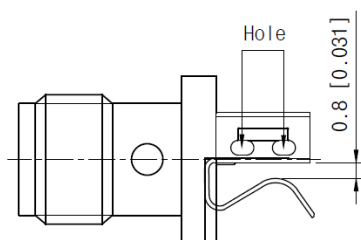
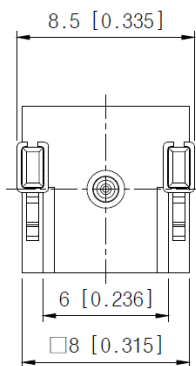
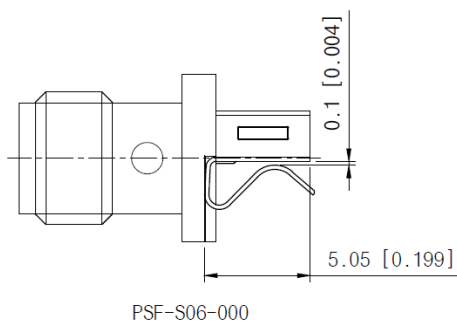

Part No.	Board Clearance
PSF-S06-000	0.25 ~ 1.2mm
PSF-S06-001	1.25 ~ 2.0mm

## ► Test result

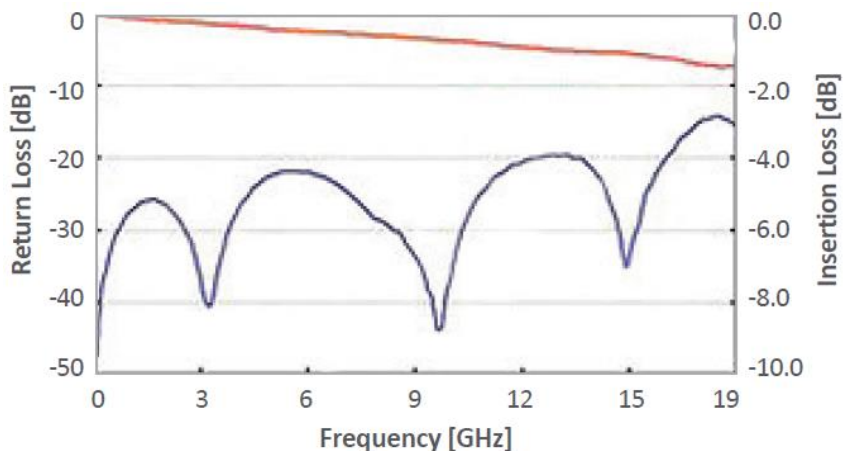

### <DUT>

- Connector
  - PSF-S06-000 : 2ea
- PCB
  - FR4 Sub Thickness : 0.6mm
  - 50Ω Line Width : 1.2mm
  - Line Length : 18mm