

SMA Connector PAF-S05 Series

www.gigalane.com



GigaLane SMA(Sub Miniature A) connectors are widely used in the frequency range DC to 18 GHz with low loss characteristics. SMA connectors are most used in military, microwave frequencies and telecommunication application.

► Specification

Electrical

Frequency	DC ~ 18 GHz
Impedance	50 Ω
VSWR	1.2 : 1 (@ 18 GHz)
Insulation Resistance	5000 M Ω
Dielectric Withstand Voltage	1000 Vrms Max
Contact Resistance - Outer Conductor - Inner Conductor	2m Ω max 3m Ω max
Insertion Loss	0.3 dB max(@26.5 GHz)
RF Leakage	-90 dB
Power Handling	200W (@2 GHz)

Mechanical

Mating Cycle (Durability)	500
Recommended Mating Torque Proof Torque	0.9 ~ 1.13 Nm / 8 ~ 10 lbs 1.7 Nm / 15.0 lbs
Coupling Nut Retention Force	270 N / 27.7 kfg / 61 lbs
Center Contact Retention Force	2.6 pound (axial)

Environmental

Temperature	- 40°C to + 125°C
Thermal Shock	MIL-STD-202, Method 107, Condition B
Corrosion (salt Spray)	MIL-STD-202, Method 101, Condition B, 5% salt
Shock	MIL-STD-202, Method 213, Condition I
Vibration	MIL-STD-202, Method 204, Condition D (20G)
Moisture Resistance	MIL-STD-202, Method 106

Materials

Body	Beryllium Copper (Gold Plated)
Center Contact	Beryllium Copper (Gold Plated)
Insulator	PTFE

SMA Connector PAF-S05 Series

www.gigalane.com

► Drawing

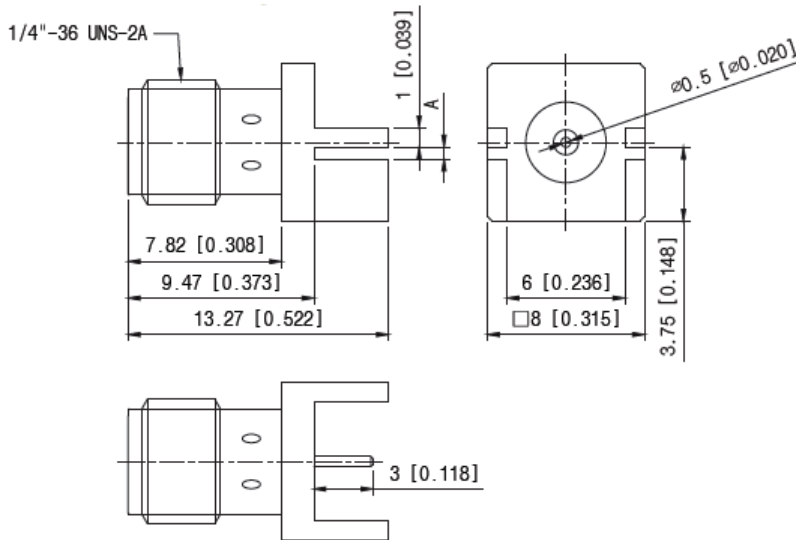

► Part Number

Unit : mm [inch]

Part No.	DIM A
PAF-S05-000	0.60 [0.024]
PAF-S05-001	0.80 [0.031]
PAF-S05-002	1.00 [0.039]
PAF-S05-003	1.10 [0.043]
PAF-S05-004	1.20 [0.047]
PAF-S05-005	1.30 [0.051]
PAF-S05-006	1.50 [0.059]
PAF-S05-007	1.60 [0.063]
PAF-S05-008	1.73 [0.068]
PAF-S05-009	2.10 [0.083]
PAF-S05-010	2.25 [0.089]
PAF-S05-011	3.60 [0.142]
Type	End Launch 13.27mm Long
Gender	Female

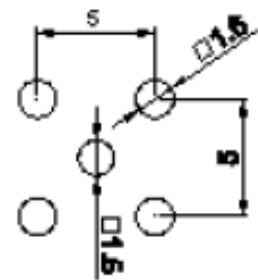

*PCB Pattern: Fig4